

LED Sign Module SMD2835 1.32W 12VDC IP65 for Illuminated Signs

OVERVIEW

The 7-57x3W-UL-L is a 12VDC constant-voltage LED sign module using three SMD2835 emitters on a single PCB. Designed for illuminated sign letters and light boxes with cabinet depths ranging from 60 mm to 180 mm, modules connect in series strings of up to 20 units and mount via 3M tape and screws.

Each module draws 1.32W and delivers 110 lumens through a 160-degree clear optic lens, with a CRI of 75 or greater. Available color temperatures span 3000K through 7000K. The module is rated IP65 for resistance to dust and low-pressure water, and is specified for operating temperatures from -25°C to +60°C.

The module carries RoHS compliance. Installation and maintenance must be performed by qualified personnel per the manufacturer's instructions. A 3-year warranty is provided. Maximum string length is 20 modules, and the power supply lead should not exceed two meters to maintain uniform output across the installation.

SPECIFICATIONS

Power	1.32 W	Input voltage	12 V DC
Luminous flux	110 lm	Dimensions	80 x 18 x 5.8 mm
CCT	3000/4000/5000/6500/7000 K	Weight	2.9 g
CRI	75	Operating temp	-25 to +60 °C
Beam angle	160 deg	Warranty	3 years
IP rating	IP65		

DIMENSION

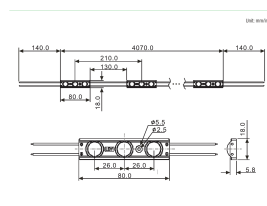

CERTIFICATIONS & COMPLIANCE



IP65